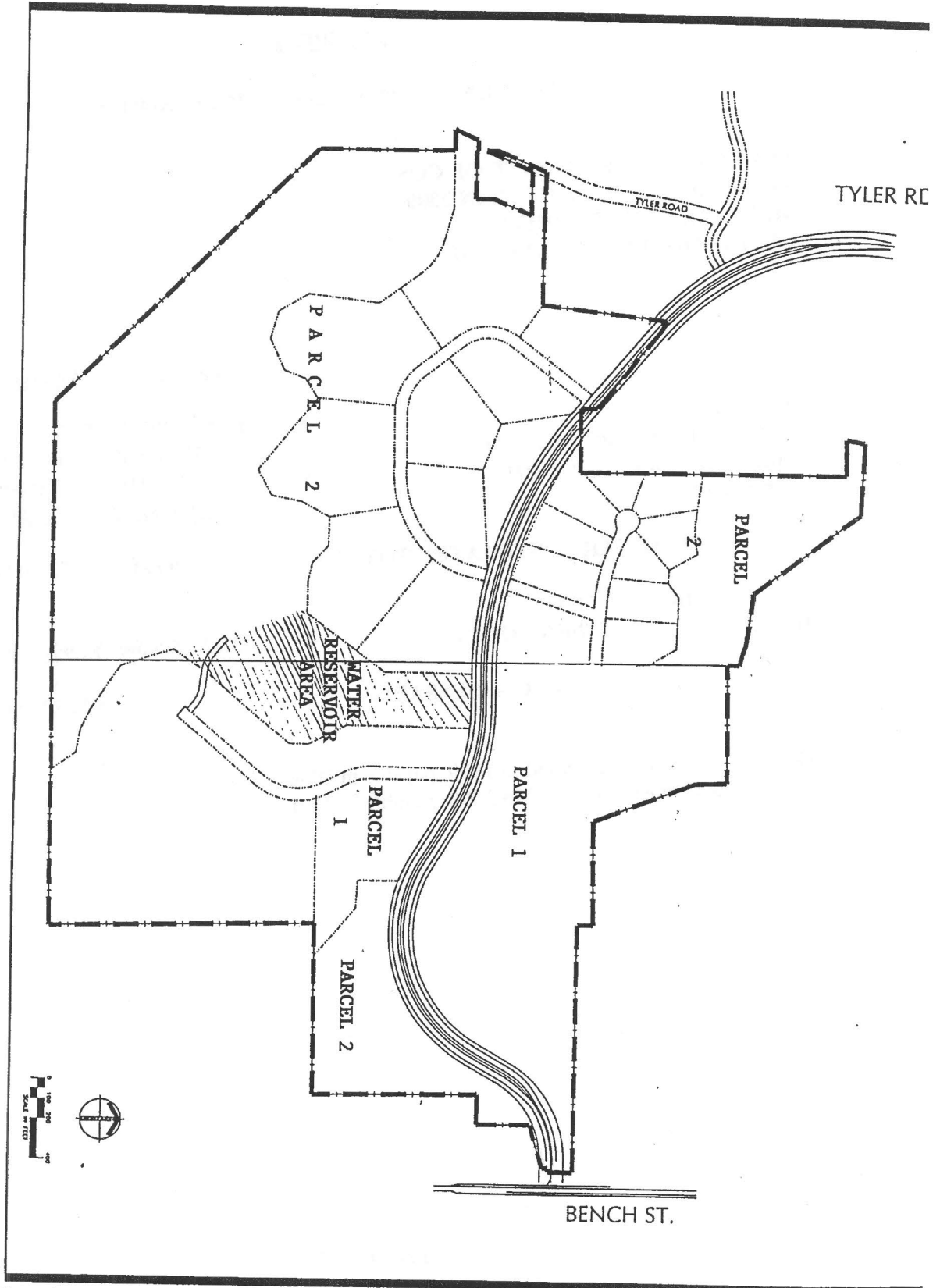

EXHIBIT G



RED WING PORT AUTHORITY
 RED WING, MINNESOTA
 BOUNDARY MAP

YAGGY COLBY ASSOCIATES

Professional Surveyors & Engineers
 212 Third Street, Red Wing, MN 55069
 Phone: 507-385-2222
 Fax: 507-385-2223
 Email: info@yaggycolby.com

DATE	1/15/2018
BY	ST/MS/MS/MS
PROJECT	RED WING PORT AUTHORITY
SCALE	AS SHOWN
REVISIONS	
NO.	DESCRIPTION
1	BOUNDARY MAP

EXHIBIT H

Special Assessments for Public Improvements

**PRELIMINARY ESTIMATE OF COST
PHASE II CONSTRUCTION IN 2000
MEDICAL CENTER DRIVE
CITY OF RED WING, MINNESOTA**

		<u>Total Cost</u>	<u>Assessable Portion</u>
Street Improvements	=	\$ 850,000.00	\$ 300,000.00 (p.2)
Lighting Improvement (Luminar)	=	250,000.00	125,000.00
Bituminous Multi-Purpose Trail	=	50,000.00	50,000.00 (p.3)
Contingencies	=	<u>100,000.00</u>	<u>50,000.00</u>

PRELIMINARY ESTIMATED TOTAL COST \$1,250,000.00 \$ 525,000.00

**TOTAL CONSTRUCTION
INCLUDING 1999 & 2000 COSTS = \$3,828,500.00 \$1,994,500.00 (p. 4)**

TOTAL ASSESSABLE = \$2,519,500.00

- 1) "1999" means assessed in 1999, payable in 2000
- 2) "2000" means assessed in 2000, payable in 2001

**PRELIMINARY ESTIMATE OF COST FOR
 PHASE II STREET IMPROVEMENTS (2000)
 MEDICAL CENTER DRIVE
 CITY OF RED WING, MINNESOTA**

	<u>Total Cost</u>	<u>Assessable Portion</u>
13,400 TONS - Bituminous Base/Binder Course @ \$25.00/Ton	= \$ 335,000.00	\$100,000.00
3,300 TONS - Bituminous Wearing Course @ \$28.00/Ton	= 92,400.00	67,200.00
100 S.Y. - Valley Gutters @ \$30.00/S.Y.	= 3,000.00	1,500.00
2,500 S.Y. - Concrete Median @ \$25.00/S.Y.	= 62,500.00	-
25,000 L.F. - Concrete Curb & Gutter @ \$8.00/L.F.	= 200,000.00	100,000.00
150 EACH - Trees @ \$500.00/Tree	= 75,000.00	-
Engineering & Contingencies	= <u>82,100.00</u>	<u>31,300.00</u>
TOTAL PRELIMINARY ESTIMATED COST	\$850,000.00	\$300,000.00

