



MN\_Cass County\_Hackensack Conservation Building\_0001  
North and east elevations, facing southwest





MN\_Cass County\_Hackensack Conservation Building\_0002  
East elevation, facing west





MN\_Cass County\_Hackensack Conservation Building\_0003  
East and south elevations, facing northwest





MN\_Cass County\_Hackensack Conservation Building\_0004  
North elevation, facing southwest





MN\_Cass County\_Hackensack Conservation Building\_0005  
South elevation, facing north





MN\_Cass County\_Hackensack Conservation Building\_0006  
South and west elevations, facing northeast





MN\_Cass County\_Hackensack Conservation Building\_0007  
West elevation, facing east





MN\_Cass County\_Hackensack Conservation Building\_0008  
Stone chimney, west elevation, facing east





MN\_Cass County\_Hackensack Conservation Building\_0009  
Center room with stone fireplace, facing west





MN\_Cass County\_Hackensack Conservation Building\_0010  
Center room, fireplace hearth and mantel, facing west





MN\_Cass County\_Hackensack Conservation Building\_0011  
Center room, upper portion of fireplace, facing west



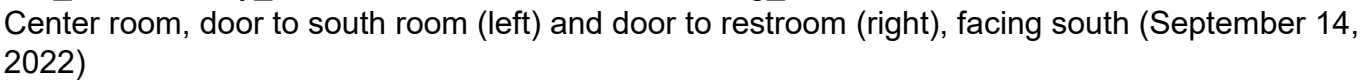









MN\_Cass County\_Hackensack Conservation Building\_0014

North room, looking from the north room into the center room with former doorway at right infilled, facing south (September 14, 2022)





MN\_Cass County\_Hackensack Conservation Building\_0015  
North room, view of south and east walls and ceiling, facing southwest





MN\_Cass County\_Hackensack Conservation Building\_0016

North room, view through casement windows toward Birch Lake, facing west (September 14, 2022)





MN\_Cass County\_Hackensack Conservation Building\_0017  
Picnic Shelter with Conservation Building at right, facing northwest (September 13, 2022)