

1 Plan
Scale: 3/16" = 1'-0"

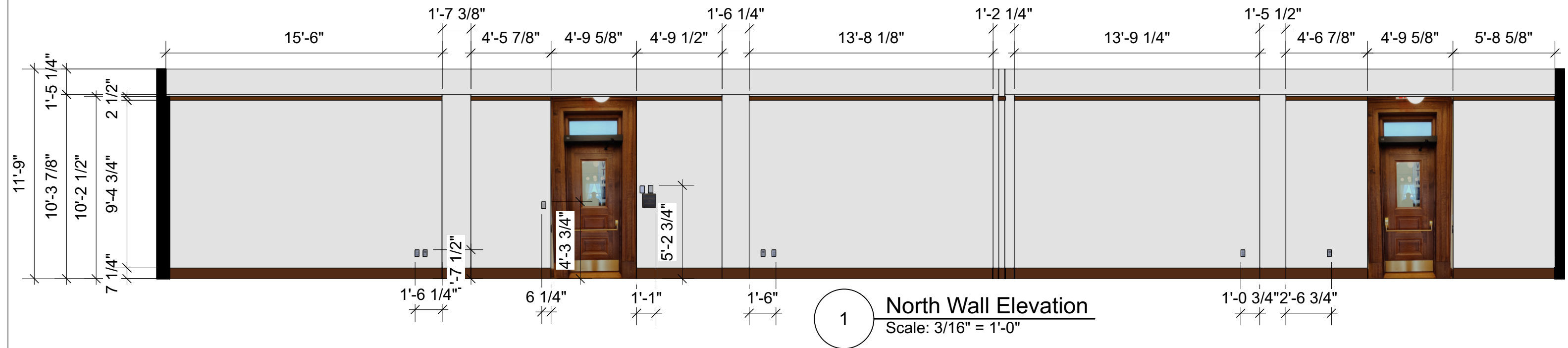

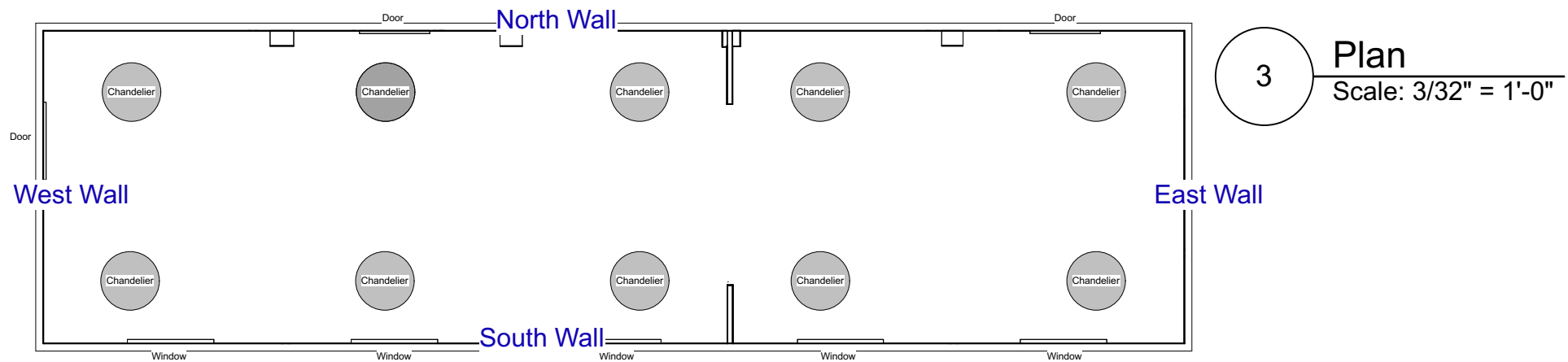

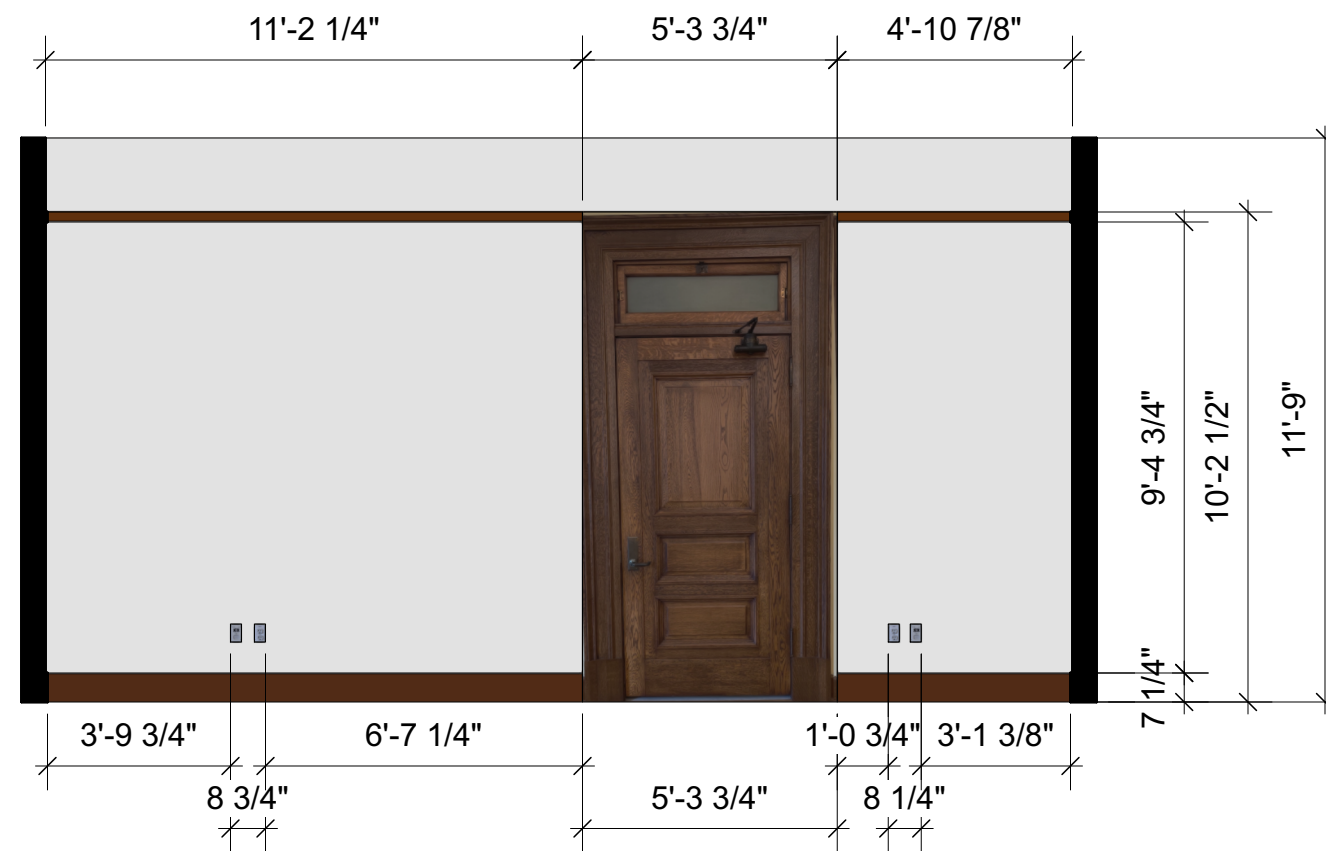
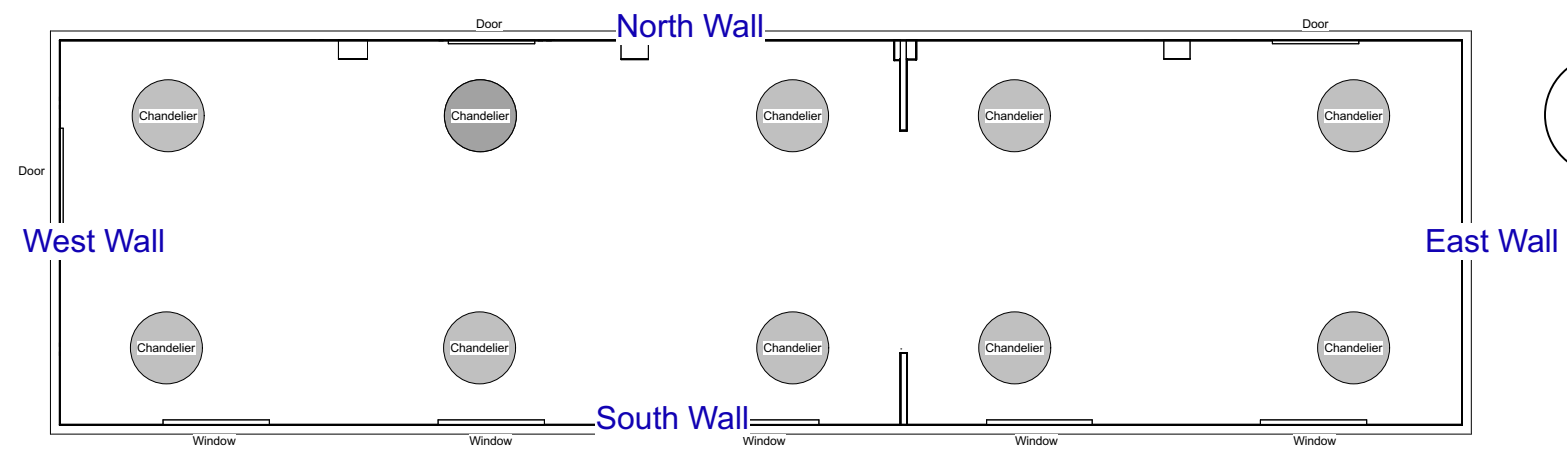
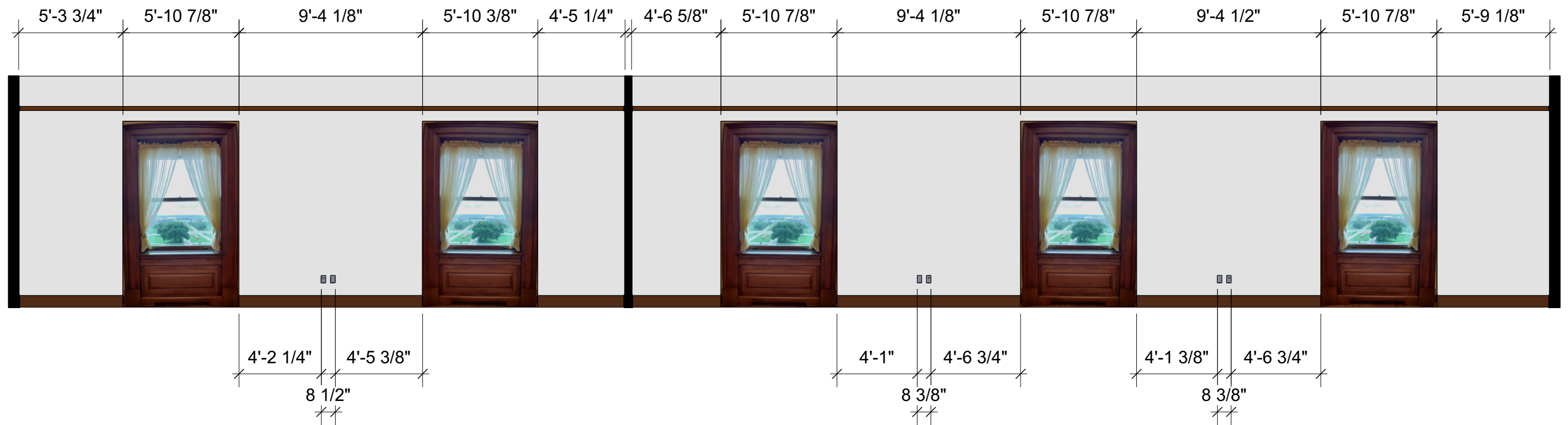
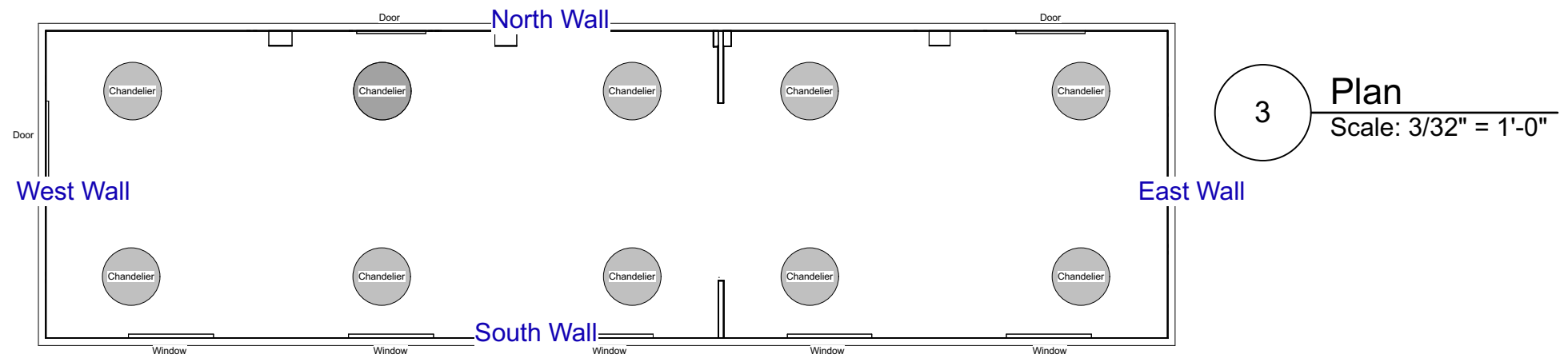

1 **South Wall Elevation**
Scale: 3/16" = 1'-0"

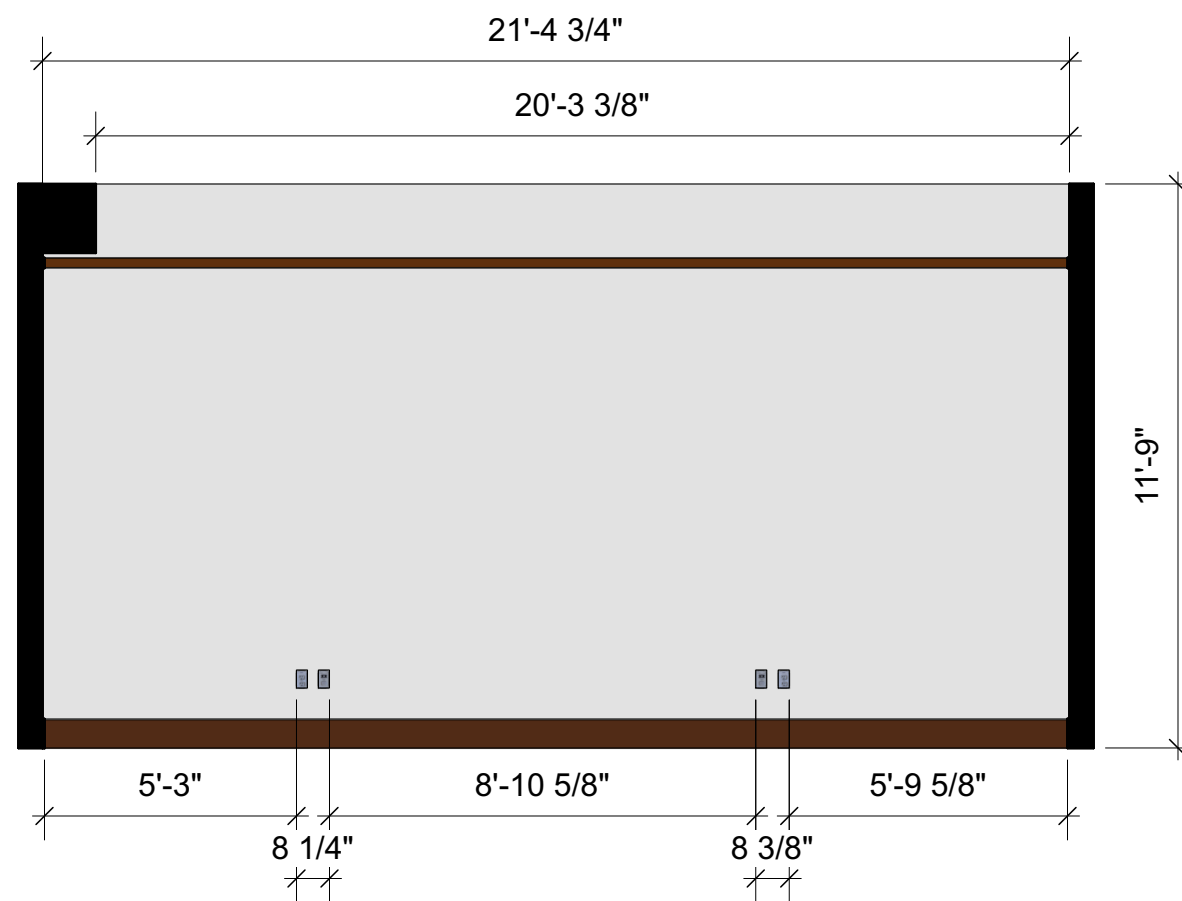
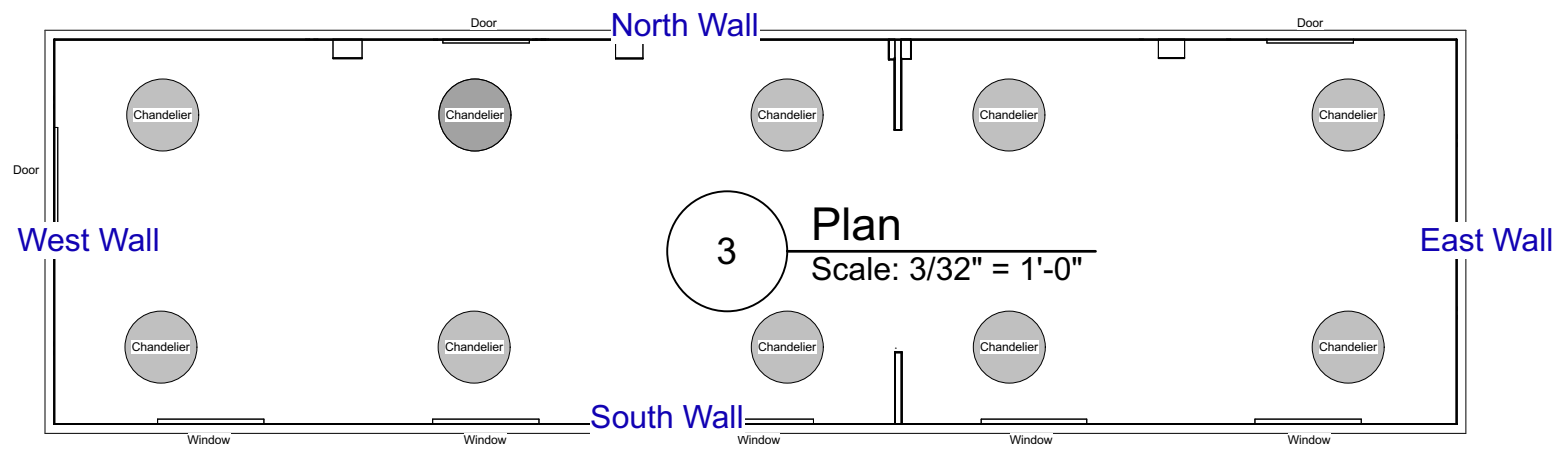

1 East Wall Elevation
Scale: 1/4" = 1'-0"

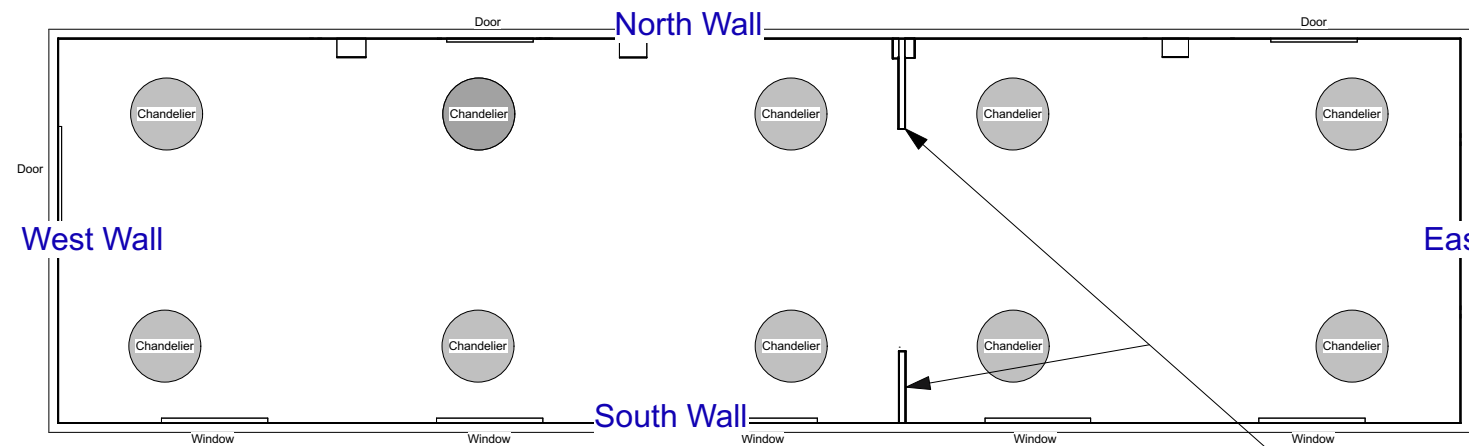

3 Plan
Scale: 3/32" = 1'-0"

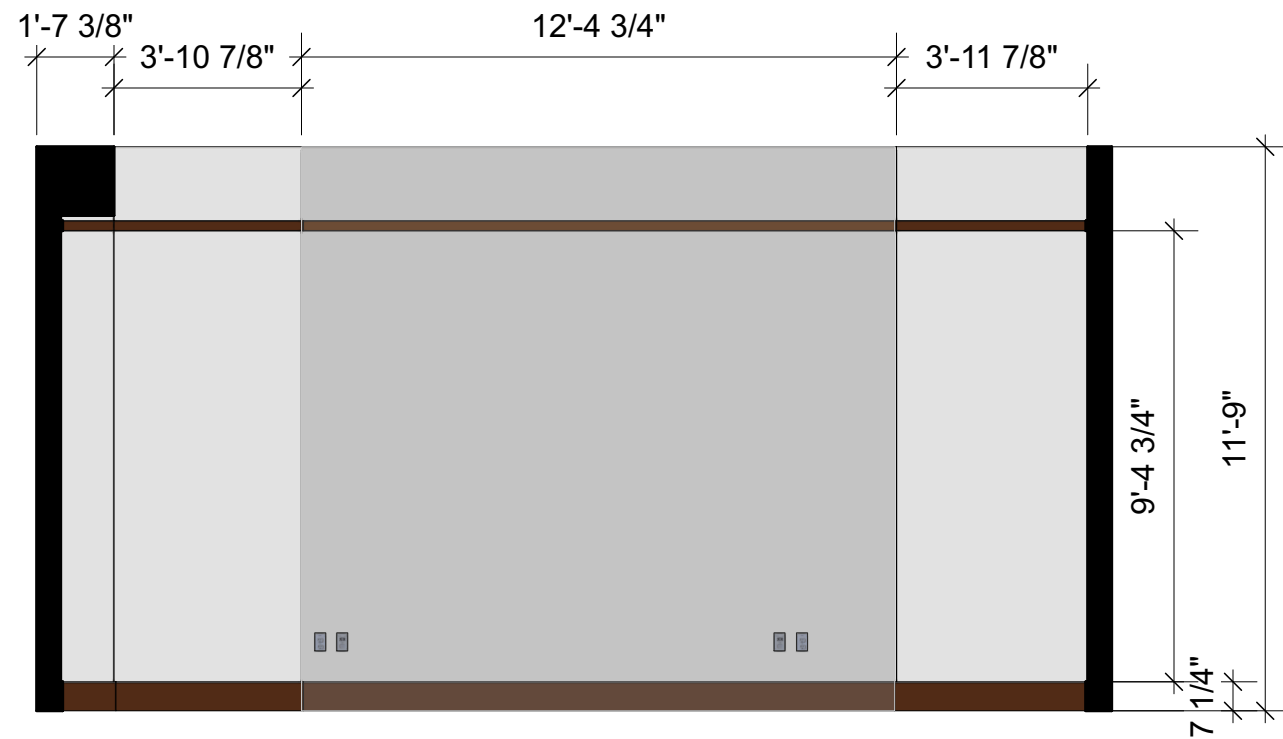

1 Central Walls View facing East
Scale: 1/4" = 1'-0"

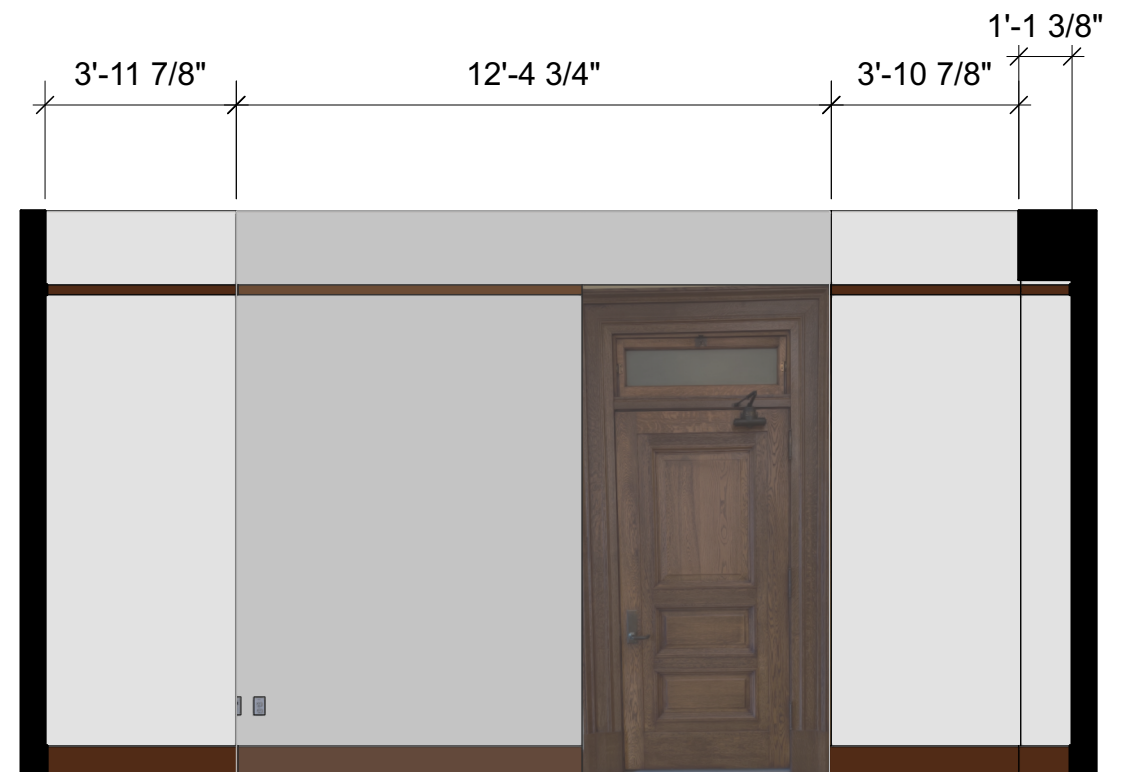

2 Central Walls View Facing West
Scale: 1/4" = 1'-0"